

S Applicazione Impronta Singola

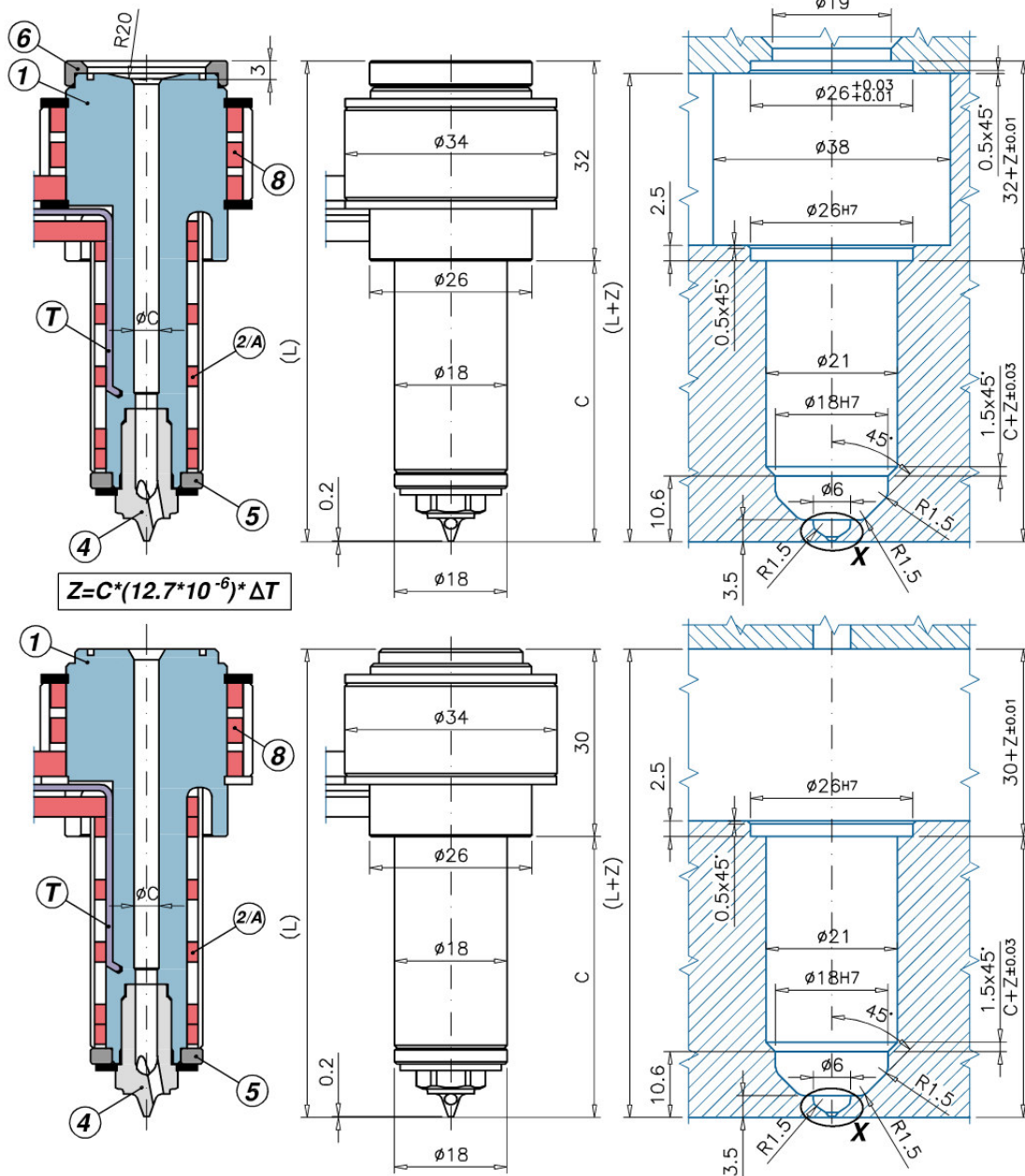

M Applicazione impronta multipla

| Ugello | C | S | | M | | 1 | A 2/A | B 2/B | T | -P | | 0/1 | | 5 | 8 |
|----------|--------------|-----|-----|----------|-----|----------|------------|----------|-------------|----|-----|----------|----------|-----------|----------|
| | | L | 6 | L | 7 | | | | | 3 | 3/P | 4/0 | 4/1 | | |
| UGEP2501 | SM A/B - 0/1 | 45 | 77 | UGAS2623 | 75 | UGCR2501 | REPNSP2001 | REDN2001 | S100851000J | | | UGPU20TZ | UGPU20CU | UGEP200AT | REPTS250 |
| UGEP2502 | SM A/B - 0/1 | 60 | 92 | UGAS2623 | 90 | UGCR2502 | REPNSP2002 | REDN2002 | S100851000J | | | UGPU20TZ | UGPU20CU | UGEP200AT | REPTS250 |
| UGEP2503 | SM A/B - 0/1 | 80 | 112 | UGAS2623 | 110 | UGCR2503 | REPNSP2003 | REDN2003 | S101051000J | | | UGPU20TZ | UGPU20CU | UGEP200AT | REPTS250 |
| UGEP2504 | SM A/B - 0/1 | 100 | 132 | UGAS2623 | 130 | UGCR2504 | REPNSP2004 | REDN2004 | S101051000J | | | UGPU20TZ | UGPU20CU | UGEP200AT | REPTS250 |

- 1 = Corpo ugello
- 2/A = Resistenza spirata
- 2/B = Resistenza in fusione
- T = Termocoppia tipo J
- 3 = Boccola
- 4 = Puntale (0= TZM 1= Cu-Be)
- 5 = Anello in titanio
- 6 = Anello di centraggio
- 7 = O-RING

- 8 = Resistenza spirata con TCJ
- ØC = Standard: 4 - A richiesta: 5
- Ød = standard: 0,6 + 1,0 - A richiesta: 1,1 + 2,0

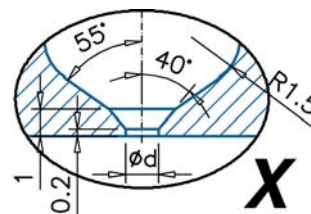

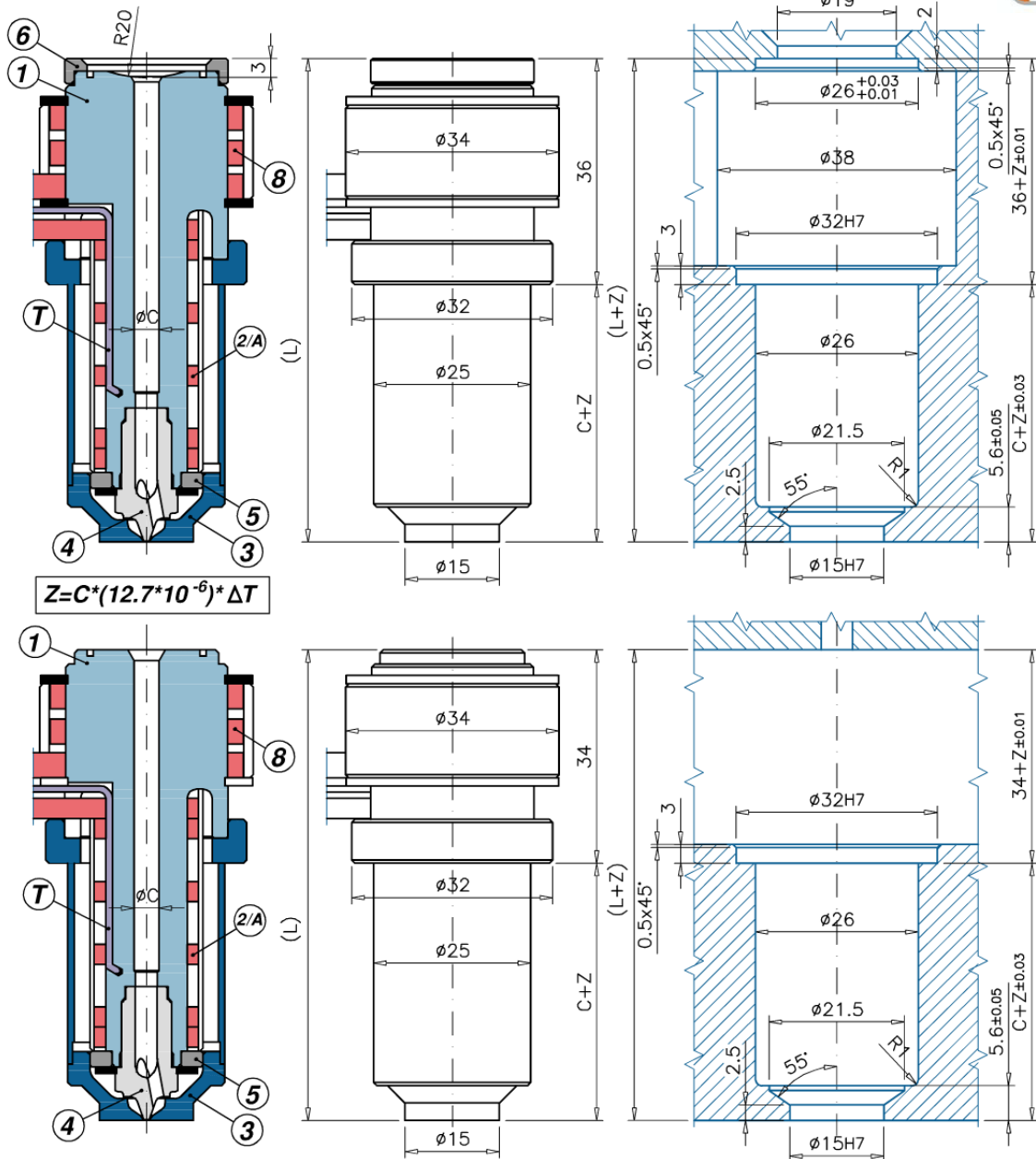
S Applicazione Impronta Singola

M Applicazione impronta multipla

| Ugello | C | S | | M | | 1 | A | B | T | 3 | -P | 3/P | 0/1 | | 5 | 8 |
|----------|---------------|----|-----|----------|-----|----------|------------|----------|-------------|---------|----|-----|----------|----------|-----------|----------|
| | | L | 6 | L | 7 | | | | | | | | 4/0 | 4/1 | | |
| UGEP2601 | S/M A/B - 0/1 | 41 | 77 | UGAS2623 | 75 | UGCR2501 | REPNSP2001 | REDN2001 | S100851000J | UGBC211 | | | UGPU20TZ | UGPU20CU | UGEP200AT | REPTS250 |
| UGEP2602 | S/M A/B - 0/1 | 56 | 92 | UGAS2623 | 90 | UGCR2502 | REPNSP2002 | REDN2002 | S100851000J | UGBC212 | | | UGPU20TZ | UGPU20CU | UGEP200AT | REPTS250 |
| UGEP2603 | S/M A/B - 0/1 | 76 | 112 | UGAS2623 | 110 | UGCR2503 | REPNSP2003 | REDN2003 | S101051000J | UGBC213 | | | UGPU20TZ | UGPU20CU | UGEP200AT | REPTS250 |
| UGEP2604 | S/M A/B - 0/1 | 96 | 132 | UGAS2623 | 130 | UGCR2504 | REPNSP2004 | REDN2004 | S101051000J | UGBC214 | | | UGPU20TZ | UGPU20CU | UGEP200AT | REPTS250 |

- 1 = Corpo ugello
- 2/A = Resistenza spiralata
- 2/B = Resistenza in fusione
- T = Termocoppia tipo J
- 3 = Boccola
- 4 = Puntale (0= TZM 1= Cu-Be)
- 5 = Anello in titanio
- 6 = Anello di centraggio
- 7 = O-RING

- 8 = Resistenza spiralata con TCJ
- ØC = Standard: 4 - A richiesta: 5
- Ød = standard: 1,0 - A richiesta: 0,6 + 2,0